

HOLE DETAIL

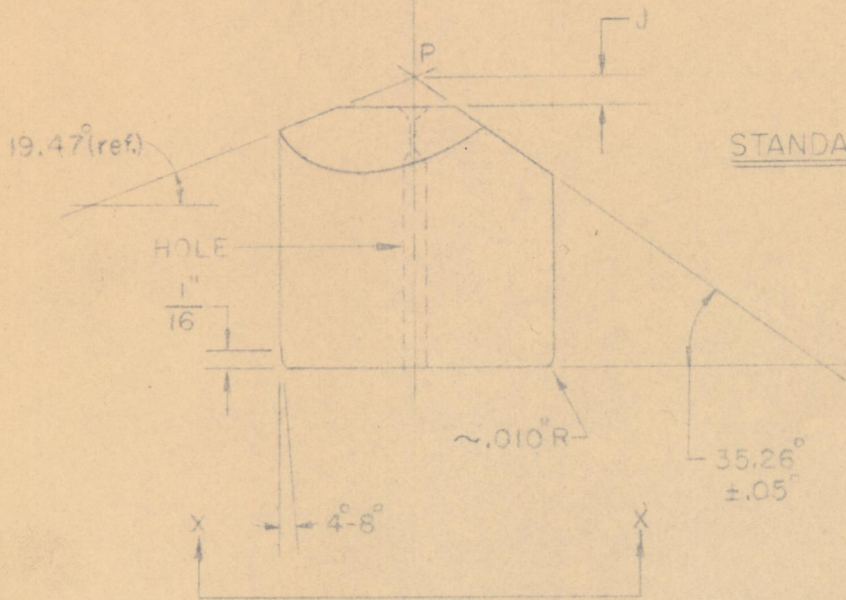

STANDARD TETRAHEDRAL ANVIL

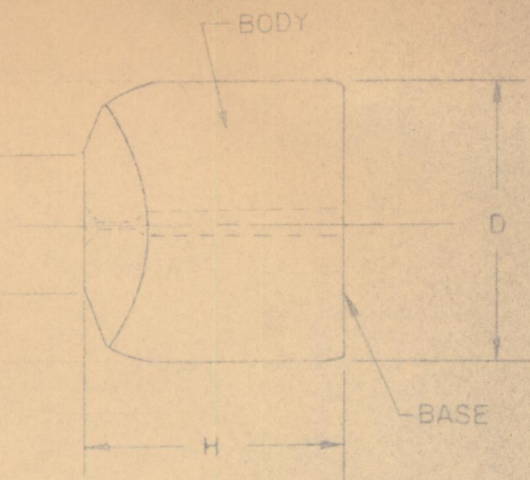
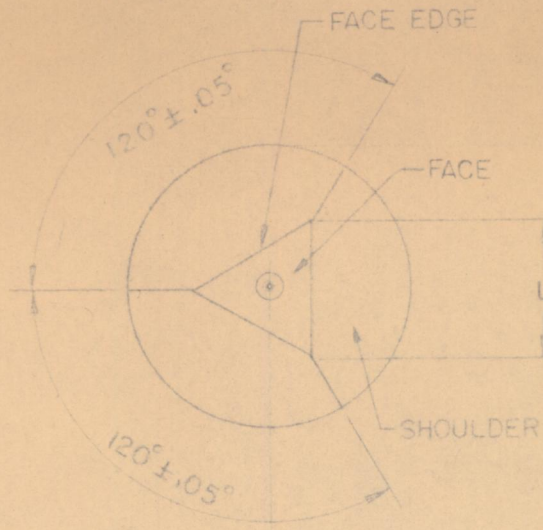
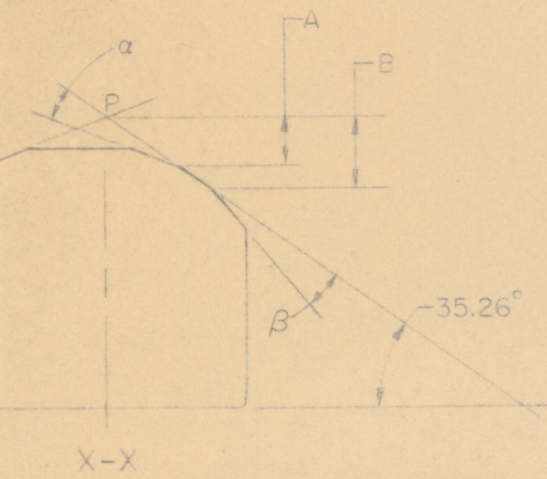

SHOULDER MODIFICATIONS

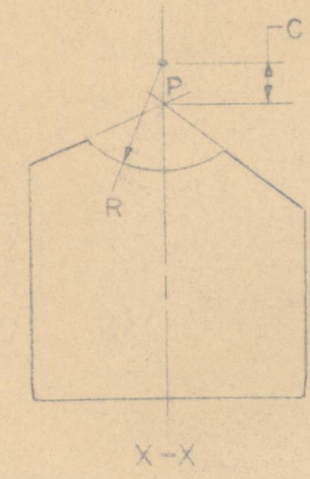

FACE MODIFICATIONS (SPHERICAL)

STANDARD ANVIL

L	J
.2500"	.0510"
.3125	.0638
.3750	.0765
.5000	.1021
.6250	.1276
.7500	.1531
.8750	.1786
1.0000	.2041
1.2500	.2552
1.5000	.3062
1.7500	.3572
2.0000	.4083

TETRAHEDRAL ANVILS

SEPT 19, 1962 H. Tracy Hall

for X-ray use, D = 1.5000 ± .0005"
H+J = 1.500"